



*Make our family farm your family tradition.*

*Our fall season of picking is approaching fast due to early spring blossom and good summer weather. The Apple Shed will be open **Friday, September 10<sup>th</sup> through Sunday, October 31<sup>st</sup>**. Apples and pears, sold by the pound, are available to pick in the orchard or select out of bins. We will have a limited quantity of Honeycrisp and Gala apples already picked and available opening day. You can also purchase apples, pears and cider from our winter storage November through April. Please visit **BlackmanHomesteadFarm.com** for weekly “**Harvest Time Updates**”. We look forward to seeing you soon.*

*The Blackman Family*

*Look for these additional offerings at the Apple Shed...*

- ◆ Fresh pressed Apple Cider
- ◆ Fruit Butters, Apple Sauces & Concord Grape Pie Filling
- ◆ Many varieties of Winter Squash, Halloween and Heirloom Pumpkins & Gourds
- ◆ Fruit Butter, Apple Sauce, and Fresh Apple Gift Boxes available for shipping
- ◆ Locally produced Maple Syrup, Honey, Caramel Popcorn and other Specialty Items
- ◆ Fresh Thanksgiving Turkeys including Heritage Breeds available to order
- ◆ Farm Animals and Straw Play Area

### 2010 Apple Picking Chart

Variety	Start Date*	Eating	Sauce	Baking
McIntosh	Sept 10	excellent	~	~
Jonamac	Sept 10	excellent	good	good
Bosc Pears	Sept 17	excellent	good	good
Spartan	Sept 17	excellent	fair	good
Greening	Sept 17	~	good	good
Cortland	Sept 17	excellent	fair	good
Macoun	Sept 17	excellent	fair	~
Empire	Sept 24	excellent	good	good
Red Delicious	Sept 24	excellent	~	~
Jonagold	Oct 1	excellent	excellent	excellent
Golden Delicious	Oct 1	excellent	excellent	good
Crispin/Mutsu	Oct 8	excellent	excellent	excellent
Ida Red	Oct 15	excellent	good	excellent
Cider	mid Sept	~	~	~
Concord Grapes	late Sept	excellent	~	excellent

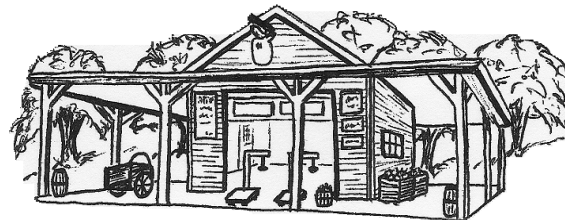

OPEN 7 DAYS A WEEK  
9 AM ~ 6 PM  
PLEASE NO PETS

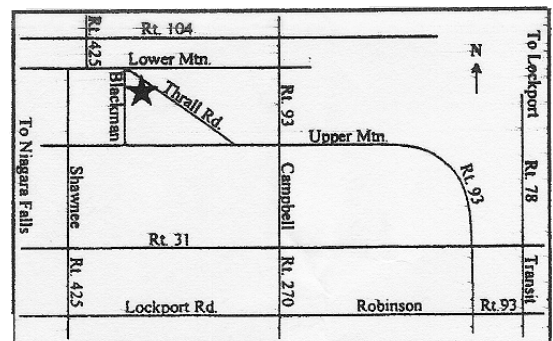

\* Depending on crop size, apples & pears are usually available to pick off the trees for one to two weeks after the start date above.

**We accept Visa, MasterCard, & Discover**

**4472 Thrall Road ♦ Lockport, NY 14094 ♦ 716.434.7116**  
**BlackmanHomesteadFarm.com**